

18 February 2019

Issue No. 001

NOTICE OF WORKS

Centre Rd and Terminal Drive intersection Line Marking
Tuesday 19th February – Wednesday 20th February

This On-Air Notice serves to notify stakeholders of the upcoming work at the Centre Rd intersection to complete line marking.

As this area is starting to show signs of wear and tear we are required to re-apply the line marking to ensure safety and visibility in this area as per the Programmed asset management program. The below TMP will be implemented and does require lane closures and detours.

The works are scheduled to take place on the following dates and times:

Tuesday 19th February 11:59PM until Wednesday 20th 04:00

Please note that work is subject to weather conditions and the schedule may change at short notice.

For any queries regarding this work please contact:

Programmed Duty Phone: 0400 384 729

Programmed Facility Manager Landside: Jarrod Wadden 0488 900 292

Melbourne Airport Facility Manager: Sandra Spiric 0457 520 981

ON Air

LANDSIDE UPDATE

Work Location



ON Air

LANDSIDE UPDATE

Traffic Management Plan

TGS #2474 Roadlinez Centre Rd and Terminal Dr, Melbourne Airport Linemarking Works

Additional Notes:

- 1) TGS to be implemented as per conditions approved by Hume Council, Vicroads and/or Melbourne Airport authority.
- 2) When implementing closure, implement Detour insert.
- 3) Works to be undertaken during off peak times. At the time of TGS creation, 4 hour shift starting at midnight.
- 4) No aftercare required.



WORK AREA

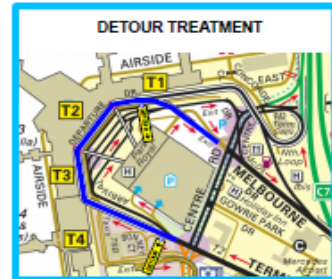
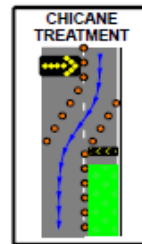

NOT TO SCALE

NOTES

Any conflicting devices to be covered for duration of work.

After TGS has been implemented an inspection is to be undertaken to ensure safety is present at the work site.

All signage to be placed as shown with all Multi Message Frames flagged with the exception of Lane Status End Road Work.

If the work site obstructs footpath movements, an alternate path of 1.5m must be available to allow pedestrians past the work area.

This TGS is to be implemented as shown. If the TGS is unable to be implemented due to unforeseen circumstances on the day of works, then the set up can be changed providing the author of the TGS & VicRoads/Council are notified, and all changes are approved & documented on the TGS.

This TGS is to be implemented by an individual who hold the qualification of RIIOHS302D or equivalent.

Momentum Traffic Control accepts no responsibility when this plan is implemented by others.

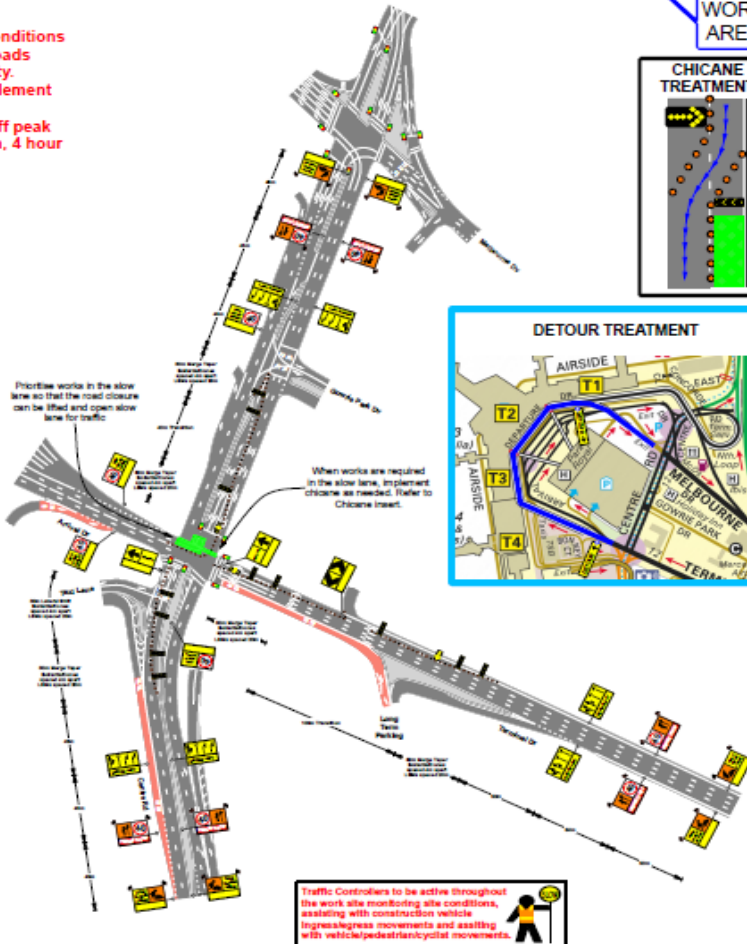
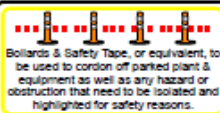

Date: 11/02/19 Author: Angus Lee - 0403 731 871 Project: Linemarking Works
Melway REF: 5 C5 APPROX VPD: >15,000 Approx work duration: 4hr Shift commencing midnight
Start TGS Date: As per Approved Permit End TGS Date: As per Approved Permit Client: Roadlinez
Client Contact: Holly Bowen - 03 5941 4248 TGS: #2474 Revision: 1



Comments:

This TGS is to be implemented as shown. TGS to be implemented as per the conditions approved by XXXX. Environmental/Weather & Traffic conditions to be assessed via the use of JSEA/Toolbox prior to implementation of work site.